

fienza®

Mirrors & Space Savers



MIRRORS • MIRROR CABINETS • SPACE SAVER VANITIES • STORAGE



Reba 800 mm Framed Mirror, Urban Brass • FMR80UB
Alina 1200 mm Fluted Wall-Hung Vanity Cabinet, Scandi Oak • 120RS-C
Crystal Pure 1200 mm Stone Top • 503-104
Koko 465 Above Counter Ceramic Basin, Gloss White • RB185

Contents

Designing your Small Space	5
Curved Mirrors	6
Rectangular Mirrors	8
Framed Mirrors	10
LED Mirrors	14
Framed LED Mirrors	19
Curved LED Mirror Cabinets	21
Curved Mirror Cabinets	22
Corner Mirror Cabinet	23
Mirror Cabinets	24
LED Mirror Cabinets	30
Siska Slim Vanities	34
Ensuite Vanities	36
InvisiCab [®]	39

All prices are Recommended Retail Prices (RRP) including GST. Prices are subject to change or correction without notification. Consumers should enquire with a retailer for actual pricing. All information is provided on an E&OE basis (Errors and Omissions Excepted). Always check fienza.com.au for the latest, up-to-date product information. Images in this brochure are shown with accessories and/or other furniture which is not included in the price, and such products may not be available within our range.

Mirrors & Space Savers

Be inspired to design your bathroom space with our extensive range of mirror styles and slim space saving vanities. Whether you want to create an illusion of space, brighten the room or add some extra storage, we offer beautiful, functional solutions for any size bathroom.



DESIGNING FOR A *Small Space*

By carefully planning the elements in your bathroom, you can create a luxurious open plan design. Explore our tips on how to maximise your bathroom space.



ATMOSPHERE

Amplify the perception of space by incorporating either artificial or natural light into your bathroom. If you don't have access to a window or skylight, opt for an LED mirror for extra illuminance.

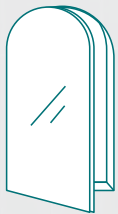

STORAGE

Keep your bathroom organised with the use of a slimline ensuite vanity or mirror cabinet. Semi-recessing your mirror cabinet into the wall increases space above your vanity without sacrificing storage. Bathroom accessories such as hooks are an easy way to add more storage without taking up too much room.



COLOUR PALETTE

Don't compromise on style in a small space! Narrow down your colour palette by choosing lighter shades to elevate the space and remove the focus from the walls. Vertical tiles can help a room appear taller while horizontal tiles can help make a room appear longer. To create a seamless look, you can match the grout colour to your tiles.



SPACE

Wall-hung vanities are perfect for creating the illusion of space by showing off more of your tiles. To save space, a wall mounted mixer is one way to keep your benchtop free from clutter and regain bench space. Be aware of your surroundings and ensure the vanity and other bathroom fixtures are clear from swinging or sliding doors.



Curved Mirrors

Our curved mirrors have a simple and clean design that will never go out of style. Available in round, pill or arch designs with a polished pencil edge, they are perfectly suited for traditional or modern bathroom designs. Our curved mirrors are quick and easy to install by simply gluing onto the wall.



5 mm
Thick Glass



Copper
Free



Resists
Corrosion

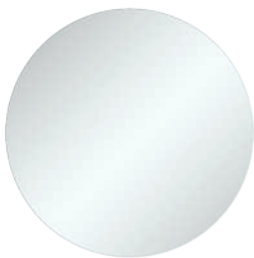

600 mm
\$99 • PEM600R

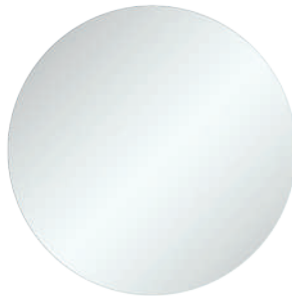

700 mm
\$99 • PEM700R

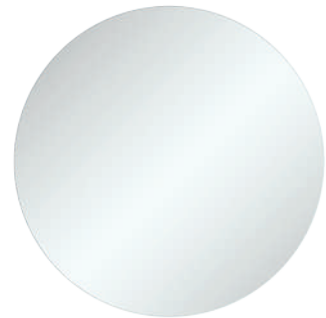

750 mm
\$109 • PEM750R

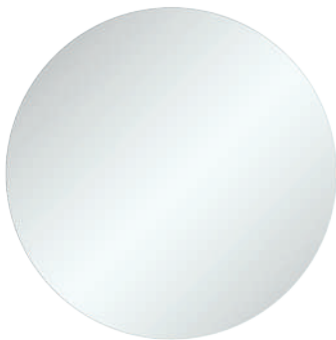

800 mm
\$119 • PEM800R

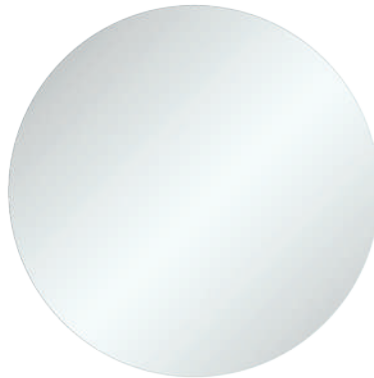

900 mm
\$125 • PEM900R



450 x 900 mm
\$249 • PEM450P



560 x 900 mm
\$279 • PEM560P



600 x 1200 mm
\$299 • PEM600P



750 x 1200 mm
\$349 • PEM750P



500 x 900 mm
\$109 • PEM500A



450 x 1175 mm
\$449 • PEM45117A



600 x 1250 mm
\$499 • PEM60125A



600 x 900 mm
\$109 • PEM600A



750 x 975 mm
\$129 • PEM750A



900 x 1050 mm
\$199 • PEM900A

Rectangular Mirrors

Elevate and enhance natural light in your bathroom with a Fienza rectangular mirror. You can choose whether to install your mirror in portrait or landscape orientation to create a focal point that accentuates your space. Our rectangular mirrors are available in a range of sizes to suit any size bathroom or ensuite. We have two installation types available, mounting bracket* or glue-on installation for selected mirror sizes.



Pencil Edge



Bevel Edge

Most sizes available in Pencil Edge or Bevel Edge



5 mm Thick Glass



Copper Free



Resists Corrosion



Mounting Brackets

450 x 600 mm
Bevel Edge \$90 • BEM-4560



Glue-on Installation

450 x 950 mm
Pencil Edge \$420 • PEM-4595



Mounting Brackets

600 x 750 mm
Bevel Edge \$115 • BEM-6075
Pencil Edge \$115 • PEM-6075



Glue-on Installation

600 x 950 mm
Pencil Edge \$500 • PEM-6095



Mounting Brackets

750 x 750 mm
Bevel Edge \$130 • BEM-7575
Pencil Edge \$130 • PEM-7575



Please note: Mirrors with mounting brackets can be installed in portrait or landscape orientation using pre-attached, non-removable brackets.



Glue-on
Installation

900 x 600 mm
Bevel Edge \$125 • BEM9060G
Pencil Edge \$125 • PEM9060G



Mounting
Brackets

1200 x 800 mm
Bevel Edge \$225 • BEM-12080



Mounting
Brackets



Glue-on
Installation

900 x 750 mm
Bevel Edge \$149 • BEM-9075
Pencil Edge \$149 • PEM-9075

Glue-On
Bevel Edge \$135 • BEM9075G
Pencil Edge \$135 • PEM9075G



Mounting
Brackets

1500 x 800 mm
Bevel Edge \$275 • BEM-15080



Mounting
Brackets



Glue-on
Installation

900 x 900 mm
Bevel Edge \$165 • BEM-9090
Pencil Edge \$149 • PEM-9090

Glue-On
Bevel Edge \$165 • BEM9090G
Pencil Edge \$149 • PEM9090G

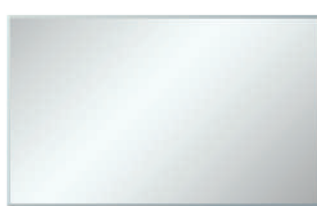

Glue-on
Installation

1500 x 900 mm
Bevel Edge \$275 • BEM15090G
Pencil Edge \$225 • PEM15090G



Mounting
Brackets

900 x 950 mm
Pencil Edge \$500 • PEM-9095



Mounting
Brackets

1800 x 800 mm
Bevel Edge \$320 • BEM-18080



Mounting
Brackets



Glue-on
Installation

1200 x 900 mm
Bevel Edge \$225 • BEM-12090
Pencil Edge \$195 • PEM-12090

Glue-On
Bevel Edge \$225 • BEM12090G
Pencil Edge \$195 • PEM12090G



Glue-on
Installation

1800 x 900 mm
Bevel Edge \$320 • BEM18090G
Pencil Edge \$299 • PEM18090G

Framed Mirrors

A mirror can change a room's ambience instantly by making the space feel larger. Make a statement with the choice of powder-coated matte white, matte black and anodised urban brass aluminium framing. For a considered design, match your framed mirror to existing décor and tapware in your bathroom.



5 mm Thick Glass



Copper Free



Resists Corrosion

Please note: Mirrors with mounting brackets can be installed in portrait or landscape orientation using pre-attached, non-removable brackets.



Can be mounted vertically or horizontally*

Empire Framed Mirror

450 X 900 MM

600 X 1200 MM

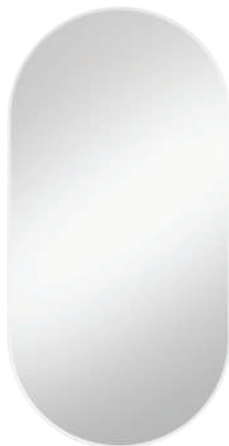

Matte White
\$390 • FMP4590W



Matte Black
\$390 • FMP4590B



Urban Brass
\$390 • FMP4590UB



Matte White
\$520 • FMP60120W



Matte Black
\$520 • FMP60120B



Urban Brass
\$520 • FMP60120UB

Reba Framed Mirror

600 MM

800 MM

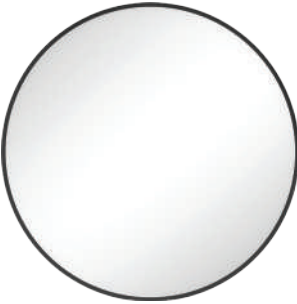

Matte Black
\$345 • FMR60B



Matte White
\$345 • FMR60W



Urban Brass
\$345 • FMR60UB

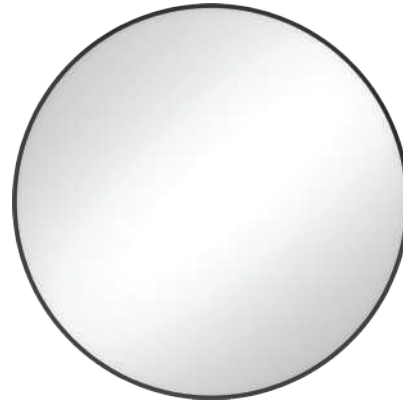

Matte Black
\$475 • FMR80B



Matte White
\$475 • FMR80W



Urban Brass
\$475 • FMR80UB

Tono Framed Mirror

500 X 800 MM

600 X 900 MM



Matte White
\$420 • FMSS5080UB



Matte Black
\$420 • FMSS5080B



Matte White
\$480 • FMSS6090UB



Matte Black
\$480 • FMSS6090B



Arch Framed Mirror

600 X 900 MM



Matte Black
\$499 • FMA6090B



Urban Brass
\$499 • FMA6090UB



Sunrise Round Framed Mirror

800 X 690 MM



Matte White
\$475 • FMSR80W

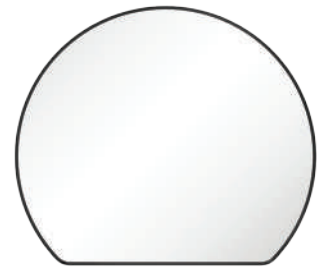

Matte Black
\$475 • FMSR80B



Urban Brass
\$475 • FMSR80UB

Pebble Asymmetrical Framed Mirror



Matte White
700 x 920 mm \$395 • FMPA7092W
900 x 1200 mm \$595 • FMPA90120W

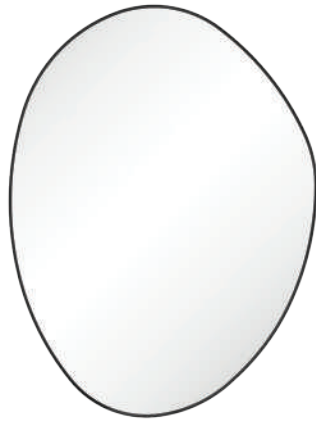

Matte Black
700 x 920 mm \$395 • FMPA7092B
900 x 1200 mm \$595 • FMPA90120B



Urban Brass
700 x 920 mm \$395 • FMPA7092UB
900 x 1200 mm \$595 • FMPA90120UB



Can be mounted vertically or horizontally*

Capriccio Asymmetrical Framed Mirror

650 X 1200 MM



Matte White
\$495 • FMCA65120W

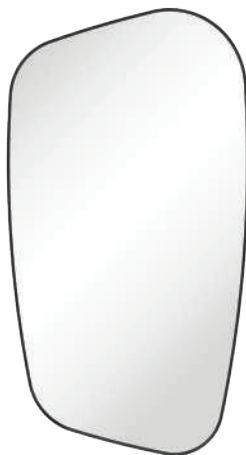

Matte Black
\$495 • FMCA65120B



Urban Brass
\$495 • FMCA65120UB

LED Mirrors

Brighten up your bathroom with our extensive range of LED mirrors. A backlit mirror creates the perfect lighting to make shaving and applying makeup easier. Each mirror comes with a built-in demister to prevent fogging and the illuminated touch sensors make operation quick and easy.



220-240
VOLTS

Concealed
Wiring



IP44
RATED

Safe for
Bathrooms



5
YEARS

5-Year
Warranty



Touch sensor for demister
& light switch

Adjustable colour temperature
(available on most models)



6000K

4000K

3000K



Sansa LED Mirror



- Cool white colour temperature (4000K)
- 12 mm thick frosted acrylic and matte white frame
- Includes wall mounting screws and anchor plugs



535 x 940 mm
\$749 • LED05-P9453



600 mm
\$599 • LED05-R60



800 mm
\$699 • LED05-R80



LED MIRRORS



Antonia LED Mirror

- Adjustable colour temperature (6000, 4000 or 3000K)
- Frosted glass frame
- Includes wall mounting screws and anchor plugs



600 x 800 mm
\$399 • LED03

Kaya® LED Mirror

- Cool white colour temperature (4000K)
- Frosted glass frame
- Includes two wall mounting hooks

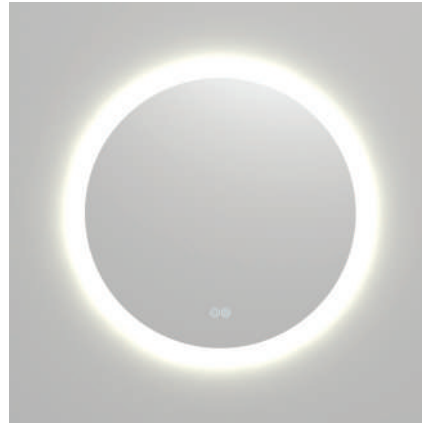

696 mm
\$549 • LED696



Luciana® LED Mirror

- Adjustable colour temperature (6000, 4000 or 3000K)
- Frosted glass frame
- Includes wall mounting screws and anchor plugs



900 x 700 mm
\$499 • LED02-90



1200 x 700 mm
\$599 • LED02-120

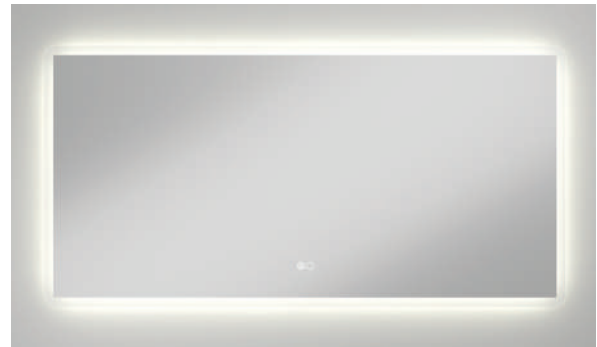

1400 x 700 mm
\$799 • LED02-140

Hampton LED Mirror

- Adjustable colour temperature (6000, 4000 or 3000K)
- Inset illuminated accent
- Includes wall mounting screws and anchor plugs



900 x 700 mm
\$479 • LED01-90



1200 x 700 mm
\$630 • LED01-120

Deejay LED Mirror

- Built-in circular magnifying mirror with 3x magnification
- Adjustable colour temperature (6000, 4000 or 3000K)
- Inset illuminated border
- Includes wall mounting screws and anchor plugs

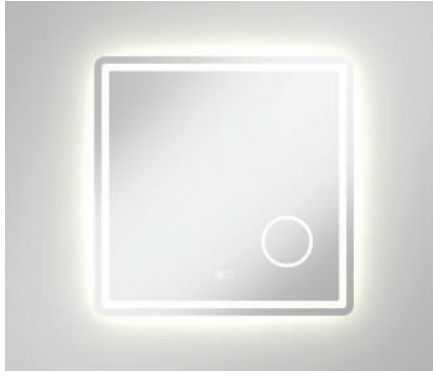

700 mm
\$399 • LED04-70

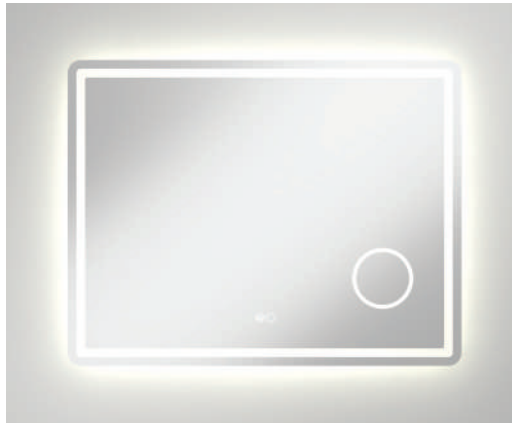

900 x 700 mm
\$499 • LED04-90



1200 x 700 mm
\$649 • LED04-120



1400 x 700 mm
\$899 • LED04-140

Framed LED Mirrors

Create a statement in your bathroom with our range of pill and round shaped Framed LED mirrors. All mirrors come with a built-in demister to prevent fogging and the illuminated touch sensor makes operation easy. The coloured aluminium frame pairs beautifully with our range of tapware, showers, and accessories.

- Adjustable colour temperature (6000, 4000 and 3000K)
- Built-in demister
- Illuminating touch sensor for light and demister
- 5mm thick glass mirror with frosted lighting
- Aluminium frame – powder-coated matte white, matte black and anodised urban brass finishes
- Copper-free to prevent corrosion



Concealed Wiring



Safe for Bathrooms



5-Year Warranty



Touch sensor for demister & light switch

Adjustable colour temperature (available on most models)

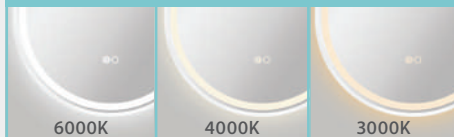

Empire LED Framed Mirror



Matte White
450 x 900 mm \$599 • LED4590FPW
600 x 1200 mm \$695 • LED60120FPW



Matte Black
450 x 900 mm \$599 • LED4590FPB
600 x 1200 mm \$695 • LED60120FPB

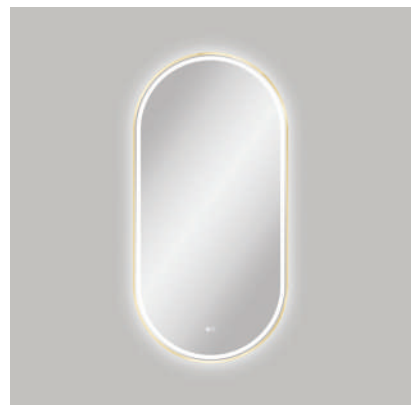

Urban Brass
450 x 900 mm \$599 • LED4590FPUB
600 x 1200 mm \$695 • LED60120FPUB

Reba LED Framed Mirror

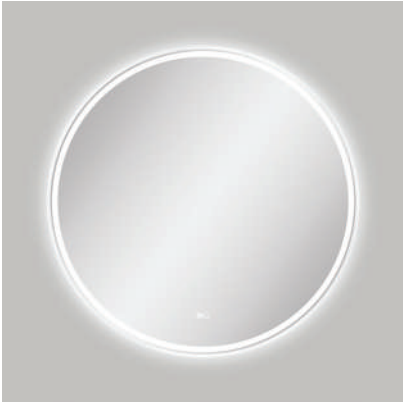

Matte White
700 mm \$599 • LED700FRW
900 mm \$699 • LED900FRW

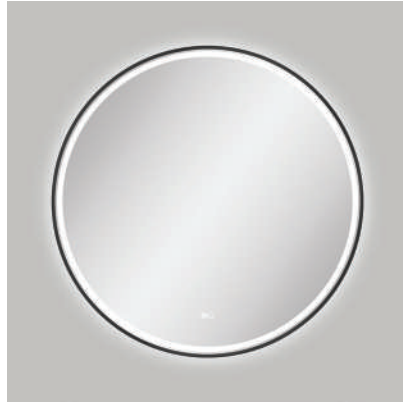

Matte Black
700 mm \$599 • LED700FRB
900 mm \$699 • LED900FRB

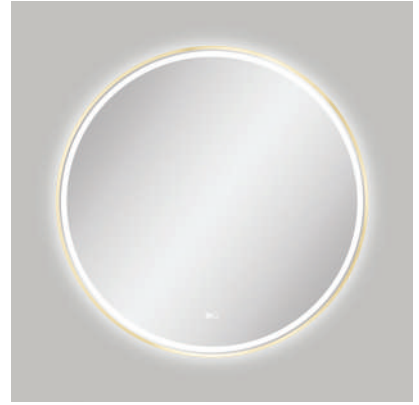

Urban Brass
700 mm \$599 • LED700FRUB
900 mm \$699 • LED900FRUB



Curved LED Mirror Cabinets

Our Curved LED Mirror Cabinets provide the perfect lighting for day & night and come fitted with a convenient internal 250V powerpoint for grooming and shaving products.

- Soft close door
- Reversible design for left or right-hand door hinge
- Archi and Pill models can be semi-recessed into wall
- One adjustable internal board shelves
- Strong 15 mm thick backing boards
- Includes wall mounting screws



3 mm Thick Glass



Copper Free



Resists Corrosion



Convenient internal 250V powerpoint



450 x 900 x 153 mm (Overall)
421 x 600 x 130 mm (Cabinet Only)
\$930 • PSH450ARCH-LED



450 x 900 x 153 mm (Overall)
421 x 540 x 130 mm (Cabinet Only)
\$930 • PSH450PILL-LED



750 x 750 x 153 mm (Overall)
500 x 500 x 130 mm (Cabinet Only)
\$930 • PSH750R-LED

Curved Mirror Cabinets

Our curved mirror cabinets are available in modern arch and pill designs. These cabinets are designed for style and function with additional storage for your bathroom.

- Soft close door
- Reversible design for left or right-hand door hinge (arch cabinet with reversible door; pill and cabinet can be rotated 180°)
- Slim design allows cabinet to be semi-recessed into wall
- Two adjustable internal board shelves
- Internal mirror with 3 x magnification
- Strong 15 mm thick backing boards
- Includes wall mounting screws



3 mm
Thick Glass



Copper
Free



Resists
Corrosion



450 x 900 x 150 mm (Overall)
420 x 600 x 132 mm (Cabinet Only)
\$499 • PSH450ARCH



Built-in circular magnifying mirror



450 x 900 x 150 mm (Overall)
420 x 480 x 132 mm (Cabinet Only)
\$499 • PSH450PILL

Corner Mirror Cabinet

Our Corner Mirror Cabinet is designed to increase storage space in your bathroom. It is the perfect solution for a those tricky corner bathroom layouts.



3 mm
Thick Glass



Copper
Free



Resists
Corrosion

- 3 mm thick glass mirror with pencil edge
- Copper-free to prevent corrosion
- Soft-close door with reversible design (rotate whole cabinet for left or right hinged door and adjust shelves)
- Two adjustable internal board shelves
- Strong 15 mm thick backing board
- Wall mounting screws included

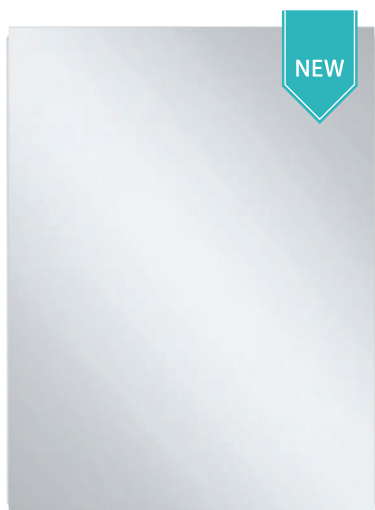

608 x 800 x 442 mm (Overall)
\$499 • PSH6080

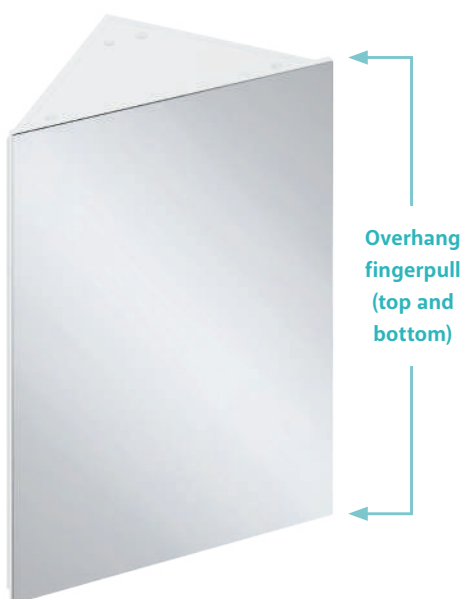

Pair with our space saving corner vanity.

Mirror Cabinets

Mirror cabinets are a versatile and practical storage solution to save space in your bathroom and keep countertops clear. Our mirror cabinet range has numerous sizes and keep configurations to choose from to suit the layout of your bathroom or ensuite. The additional side shelf is perfectly suited for home décor or alternatively, provides quick and easy access to toiletries.

- Soft-close doors
- Three adjustable internal board shelves
- 2-Pac gloss white finish
- Cabinet can be semi-recessed into wall (excludes side shelves)
- Strong 16 mm thick backing boards
- Easy to install with high quality backing boards, fixings can be placed anywhere through the back of the cabinet



5 mm
Thick Glass



Copper
Free



Resists
Corrosion

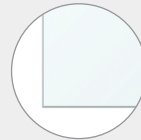

Pencil Edge



Bevel Edge

Most sizes available in
Pencil Edge or Bevel Edge



Our 450 mirror cabinet provides extra storage for a clutter free space

PRODUCT
SPECIFICATIONS
Find detailed specifications for
all products on our website:
fienza.com.au

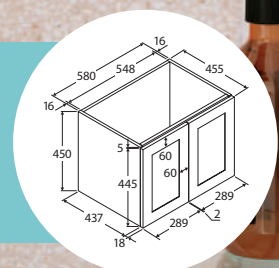



Reversible Side Shelf can be mounted on the left or right-side of the cabinet. Can also be wall mounted in a corner without the mirror cabinet.

Side Shelf for Mirror Cabinet

150 W x 720 H x 150 D mm

\$165 • SH150



300 Cabinet

300 W x 720 H x 150 D mm

Bevel edge \$180 • B300
Pencil edge \$180 • PSH300



450 Cabinet

450 W x 720 H x 150 D mm

Pencil edge \$189 • PSH450



600 Cabinet

600 W x 720 H x 150 D mm

Bevel edge \$210 • B600
Pencil edge \$210 • PSH600



600 Cabinet, 1 Side Shelf

750 W x 720 H x 150 D mm

Bevel edge \$375 • BS75
Pencil edge \$375 • PS75



600 Cabinet, 2 Side Shelves

900 W x 720 H x 150 D mm

Bevel edge \$540 • BSS90
Pencil edge \$540 • PSS90



750 Cabinet

750 W x 720 H x 150 D mm

Bevel edge \$240 • B750
Pencil edge \$255 • PSH750



750 Cabinet, 1 Side Shelf

900 W x 720 H x 150 D mm

Bevel edge \$405 • BS90
Pencil edge \$405 • PS90



750 Cabinet, 2 Side Shelves

1050 W x 720 H x 150 D mm

Bevel edge \$570 • BSS105
Pencil edge \$570 • PSS105



900 Cabinet

900 W x 720 H x 150 D mm

Bevel edge \$285 • B900
Pencil edge \$299 • PSH900



900 Cabinet, 1 Side Shelf

1050 W x 720 H x 150 D mm

Bevel edge \$440 • BS105
Pencil edge \$440 • PS105



900 Cabinet, 2 Side Shelves

1200 W x 720 H x 150 D mm

Bevel edge \$605 • BSS120
Pencil edge \$605 • PSS120



1200 Cabinet

1200 W x 720 H x 150 D mm

Bevel edge \$390 • B1200
Pencil edge \$390 • PSH1200



1200 Cabinet, 1 Side Shelf

1350 W x 720 H x 150 D mm

Bevel edge \$555 • BS135
Pencil edge \$555 • PS135



1200 Cabinet, 2 Side Shelves

1500 W x 720 H x 150 D mm

Bevel edge \$720 • BSS150
Pencil edge \$720 • PSS150

Mirror Cabinets WITH SIDE PANELS

Designed with side panels in various finishes, our mirror cabinets complement and match our universal vanity cabinets. Choose from our range of decorative finishes to create a cohesive design in your bathroom.

- Pencil edge glass mirrors
- Copper-free to prevent corrosion
- Soft-close doors
- Two adjustable internal tempered glass shelves
- White interior
- Cabinets can be semi-recessed into wall
- Made from E1 MDF board
- Strong 16 mm backing boards
- Includes 4 mounting brackets



5 mm Thick Glass



Copper Free



Resists Corrosion



PRODUCT SPECIFICATIONS

Find detailed specifications for all products on our website: fienza.com.au

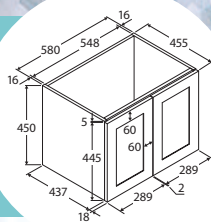

Cabinet Style

600 mm

600 W x 670 H x 180 D mm



Gloss White



\$345 • PSC600W



Satin White



\$345 • PSC600MW



Scandi Oak



\$345 • PSC600S



Industrial



\$345 • PSC600X



Satin Black



\$399 • PSC600B

750 mm
750 W x 670 H x 180 D mm

900 mm
900 W x 670 H x 180 D mm

1200 mm
1200 W x 670 H x 180 D mm

1500 mm
1500 W x 670 H x 180 D mm



\$375 • PSC750W



\$410 • PSC900W



\$335 • PSC1200W



\$780 • PSC1500W



\$410 • PSC750MW



\$460 • PSC900MW



\$585 • PSC1200MW



\$830 • PSC1500MW



\$375 • PSC750S



\$410 • PSC900S



\$535 • PSC1200S



\$780 • PSC1500S



\$375 • PSC750X



\$410 • PSC900X



\$535 • PSC1200X



\$780 • PSC1500X



\$410 • PSC750B



\$510 • PSC900B



\$635 • PSC1200B



\$880 • PSC1500B

Mirror Cabinets WITH DISPLAY SHELF

Designed with side panels and a display shelf in various finishes, our mirror cabinets complement and match our universal vanity cabinets. The additional display shelf is ideal for showcasing décor to decorate your bathroom space.



5 mm
Thick Glass



Copper
Free



Resists
Corrosion

- Open display shelf
- Pencil edge glass mirrors
- Soft-close doors
- Two adjustable internal tempered glass shelves
- White interior
- Cabinets can be semi-recessed into wall
- Strong 16 mm backing boards
- Includes 4 mounting brackets

Two Tone Customisation Option

Satin White



750 mm
\$140 • IN75MW
900 mm
\$160 • IN90MW
1200 mm
\$200 • IN120MW

Scandi Oak



750 mm
\$140 • IN75S
900 mm
\$160 • IN90S
1200 mm
\$200 • IN120S

Industrial



750 mm
\$140 • IN75X
900 mm
\$160 • IN90X
1200 mm
\$200 • IN120X

Satin Black



750 mm
\$180 • IN75B
900 mm
\$200 • IN90B
1200 mm
\$240 • IN120B

Example



750 mm display shelf cabinet with satin black shelf insert

Create a two-toned style by selecting a different finish for your shelf insert

PRODUCT
SPECIFICATIONS
Find detailed specifications for
all products on our website:
fienza.com.au

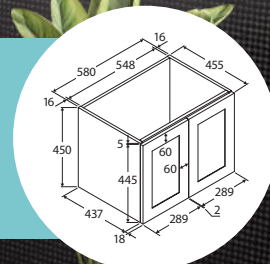

Cabinet Style

750 mm
750 W x 850 H x 180 D mm

900 mm
900 W x 850 H x 180 D mm

1200 mm
1200 W x 850 H x 180 D mm



Gloss White



\$425 • PSC750SW



\$490 • PSC900SW



\$635 • PSC1200SW



Satin White



\$445 • PSC750SMW



\$540 • PSC900SMW



\$640 • PSC1200SMW



Scandi Oak



\$425 • PSC750SS



\$490 • PSC900SS



\$635 • PSC1200SS



Industrial



\$425 • PSC750SX



\$490 • PSC900SX



\$635 • PSC1200SX



Satin Black



\$470 • PSC750SB



\$575 • PSC900SB



\$690 • PSC1200SB

LED Mirror Cabinets

WITH SIDE PANELS

Brighten up your bathroom with our extensive range of LED mirror cabinets. The combination of the LED light channel along the top of the cabinet and double-sided glass mirror doors allows for easy application of makeup and shaving. All cabinets have illuminating touch sensors for light and built-in demister to make operation easy.



3 mm
Thick Glass



Plug-In
Wiring



Safe for
Bathrooms

- Cool white colour temperature (4000K)
- Double sided, pencil edge glass mirror doors
- Built-in demister (1200 mm cabinet: left and right doors only)
- Illuminating touch sensors for light and demister
- Brightness of light is adjustable by holding your finger on the touch sensor for 5 seconds (when the light is ON)
- Two adjustable internal tempered glass shelves
- Cabinets can be semi-recessed into wall
- Includes wall mounting screws and anchor plugs
- 220-240V AC 50/60Hz with plug – no electrician installation required



PRODUCT SPECIFICATIONS

Find detailed specifications for all products on our website:
fienza.com.au

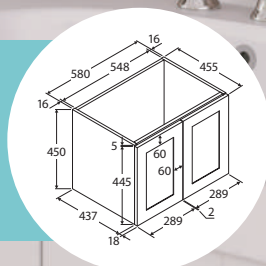

Cabinet Style

LED 750 mm
750 W x 670 H x 180 D mm

LED 900 mm
900 W x 670 H x 180 D mm

LED 1200 mm
1200 W x 670 H x 180 D mm



Gloss White



\$930 • PSC750W-LED



\$980 • PSC900W-LED



\$1180 • PSC1200W-LED



Satin White



\$980 • PSC750MW-LED



\$1030 • PSC900MW-LED



\$1230 • PSC1200MW-LED



Scandi Oak



\$930 • PSC750S-LED



\$980 • PSC900S-LED



\$1180 • PSC1200S-LED



Industrial



\$930 • PSC750X-LED



\$980 • PSC900X-LED



\$1180 • PSC1200X-LED



Satin Black



\$1030 • PSC750B-LED



\$1080 • PSC900B-LED



\$1280 • PSC1200B-LED

LED Mirror Cabinets WITH DISPLAY SHELF

Our functional and stylish LED mirror cabinets with display shelf have the same features of our LED mirror cabinets but with an added display shelf for easy to reach items. All cabinets have illuminating touch sensors for light and built-in demister to make operation easy.



3 mm
Thick Glass



Plug-In
Wiring



Safe for
Bathrooms

- Cool white colour temperature (4000K)
- Double-sided, pencil edge glass mirror doors
- Built-in demister (1200 mm cabinet: left and right doors only)
- Brightness of light is adjustable by holding your finger on the touch sensor for 5 seconds (once the light is ON)
- Open display shelf
- Two adjustable internal tempered glass shelves
- Cabinets can be semi-recessed into wall
- Includes wall mounting screws and anchor plugs
- 220-240V AC 50/60Hz with plug – no electrician installation required



PRODUCT SPECIFICATIONS

Find detailed specifications for all products on our website: fienza.com.au

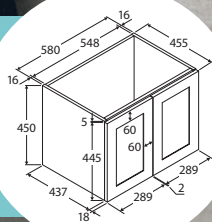

Cabinet Style

LED 750 mm
750 W x 850 H x 180 D mm

LED 900 mm
900 W x 850 H x 180 D mm

LED 1200 mm
1200 W x 850 H x 180 D mm



Gloss White



\$980 • PSC750SW-LED



\$1030 • PSC900SW-LED



\$1230 • PSC1200SW-LED



Satin White



\$1035 • PSC750SMW-LED



\$1090 • PSC900SMW-LED



\$1310 • PSC1200SMW-LED



Scandi Oak



\$980 • PSC750SS-LED



\$1030 • PSC900SS-LED



\$1230 • PSC1200SS-LED



Industrial



\$980 • PSC750SX-LED



\$1030 • PSC900SX-LED



\$1230 • PSC1200SX-LED



Satin Black



\$1090 • PSC750SB-LED



\$1145 • PSC900SB-LED



\$1385 • PSC1200SB-LED

Siska Slim Vanities

Our Siska Slim Vanities are designed to optimise space in small bathroom or washroom areas with a narrow depth of 365 mm. The neutral whites will create a crisp and clean look that will complement any bathroom style. The Siska cabinetry features a u-shape fingerpull channel and full extension drawer runners for easy operation and functional storage.

- Gloss white vitreous china basin-top
- Requires 32 mm overflow waste (available separately)
- 12 o'clock tap hole as standard
- Satin white finish on cabinet (70% matte, 30% gloss for easy cleaning)



For 3 tap holes add \$50 to the price and '-3' to the end of code e.g. 75DFL-3



Eco Friendly
E0 Board



Soft Close
Doors &
Drawers



5-Year
Warranty



PRODUCT SPECIFICATIONS

Find detailed specifications for all products on our website: fienza.com.au

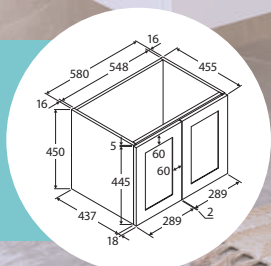

Wall-Hung Vanity

Vanity on Kickboard

SISKA 600



610 W x 650 H x 365 D mm
\$529 • 60DF



610 W x 850 H x 365 D mm
\$579 • 60DFK

SISKA 750



755 W x 650 H x 365 D mm
Left drawers \$670 • 75DFL
Right drawers \$670 • 75DFR



755 W x 850 H x 365 D mm
Left drawers \$729 • 75DFKL
Right drawers \$729 • 75DFKR

SISKA 900



905 W x 650 H x 365 D mm
Left drawers \$759 • 90DFL
Right drawers \$759 • 90DFR



905 W x 850 H x 365 D mm
Left drawers \$829 • 90DFKL
Right drawers \$829 • 90DFKR

SISKA 1200



1205 W x 650 H x 365 D mm
\$1135 • 120DF



1205 W x 850 H x 365 D mm
\$1224 • 120DFK

Ensuite Vanities

Our range of ensuite vanities are specifically designed for the smallest spaces in bathrooms, washrooms, and powder rooms. The vanity can become the main focal point in a small bathroom based on its style, colour and material. Choose from our scandi oak or industrial designs for a textured finish or keep it simple with our satin white cabinetry.



Soft Close
Doors &
Drawers



16 mm
Board



5-Year
Warranty



PRODUCT SPECIFICATIONS

Find detailed specifications for all products on our website: fienza.com.au

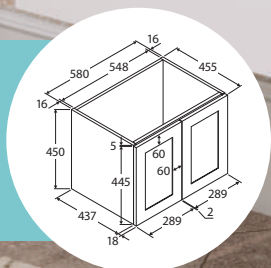

Wall-Hung Vanity

Vanity on Kickboard

DENZEL 450

- Reversible, gloss white vitreous china basin-top (no overflow)
- 1 tap hole
- Requires 32mm non-overflow waste (available separately)



REVERSIBLE
BASIN



452 W x 560 H x 250 D mm
\$430 • 4525DW



452 W x 890 H x 250 D mm
\$430 • 4525DWK

DENZEL EDGE 450

- Reversible, gloss white vitreous china basin-top (no overflow)
- 1 tap hole
- Requires 32mm non-overflow waste (available separately)
- Reversible, soft close door for left-hand or right-hand opening
- Bevelled edge pull-channel (long edge of door)
- Textured finish on exterior and interior



REVERSIBLE
BASIN



452 W x 600 H x 250 D mm
Satin White \$580 • 45DW



452 W x 890 H x 250 D mm
Satin White \$630 • 45DWK



452 W x 600 H x 250 D mm
Scandi Oak \$530 • 45DS



452 W x 890 H x 250 D mm
Scandi Oak \$580 • 45DSK



452 W x 600 H x 250 D mm
Industrial \$530 • 45DX



452 W x 890 H x 250 D mm
Industrial \$580 • 45DXK

Find more ensuite-depth vanity options in our Australian Made Vanities brochure. Ask in-store for your take-home copy or scan the QR code to browse online.



EDGE 450

- Reversible, gloss white poly-marble basin-top
- Requires 32mm waste (overflow or non-overflow depending on model; available separately)
- Reversible, soft close door for left-hand or right-hand opening
- Bevelled edge pull-channel (long edge of door)



REVERSIBLE
BASIN

Waste centred
on overflow model



With Overflow



No Overflow

Wall-Hung Vanity

Vanity on Kickboard



450 W x 695 H x 250 D mm
Satin White
No Overflow \$549 • 45RW
With Overflow \$580 • 45RW-OF



450 W x 915 H x 250 D mm
Satin White
No Overflow \$599 • 45RWK
With Overflow \$630 • 45RWK-OF



450 W x 695 H x 250 D mm
Scandi Oak
No Overflow \$499 • 45RS
With Overflow \$530 • 45RS-OF



450 W x 915 H x 250 D mm
Scandi Oak
No Overflow \$549 • 45RSK
With Overflow \$580 • 45RSK-OF



450 W x 695 H x 250 D mm
Industrial
No Overflow \$499 • 45RX
With Overflow \$530 • 45RX-OF



450 W x 915 H x 250 D mm
Industrial
No Overflow \$549 • 45RXK
With Overflow \$580 • 45RXK-OF

InvisiCab®

CONCEALED BATHROOM CABINET

InvisiCab® arose from a desire to reduce clutter in bathrooms and complement a minimalist lifestyle by making storage 'invisible'. Experience the freedom to design the bathroom you want without compromising on style and aesthetic.

- Conceals toiletries for a clutter-free bathroom
- Designed to fit seamlessly with wall tiles
- Easy-push open & closing mechanism
- Polished mirror-finish interior
- 316 marine-grade stainless steel
- Industrial strength door hinges to hold tile weight (left side only)
- Water glides away easily

INVISICAB®

PATENT
PENDING



INVISICAB 300

300 x 300 mm
\$330 • IN3030



InvisiCab® conceals toiletries to maintain a sleek look in your bathroom



INVISICAB 600

300 x 600 mm
\$390 • IN6030



fienza®

Beautiful, quality
Bathware

At Fienza our core passion is to excite customers with new, innovative and cutting-edge designer bathroom products.

Our commitment to international quality standards has ensured that Fienza continues to be the preferred choice for beautiful bathrooms and kitchens all over Australia.

Fienza® products are available through all leading bathroom and plumbing retailers.

For more information, contact us or visit our website:

P (07) 3490 6700

E info@fienza.com.au

www.fienza.com.au

Retailer/Distributor: